

# EVERY VALUABLE MOMENT



T: 0800 SUDIMA (New Zealand) / +64 9 551 8888 (International)  
E: [conference.saa@sudimahotels.com](mailto:conference.saa@sudimahotels.com) | W: [sudimahotels.com](http://sudimahotels.com)

**SUDIMA**  
HOTELS

# OUR PASSION IS YOU - WE CARE, WE DO THE RIGHT THING, WE WORK TOGETHER

At Sudima Hotels, our passion is people.

For our guests on holiday, we are a gateway to new adventures and experiences. The start of new memories. For our business guests, we are here at the end of a long day on the road or at the start of a busy day of meetings.

Regardless of the reason people choose us we feel a real responsibility to get it right. We pride ourselves on providing a friendly personal service in a welcoming and unpretentious manner, and we genuinely care – for our guests, our staff, our communities and our environment.

Our passion is you – we care, we do the right thing, we work together – and we are here to help you make the most of your day. Nothing makes us happier than when we can put a smile on your face.

# MAKING BUSINESS A PLEASURE

At Sudima Hotels we see the value in every moment of a conference, event or business meeting. That's why we take care of the little things that make you smile and help you make the most of your day. Whether it's for business or pleasure, there's nothing better than people getting together with other people. The atmosphere changes, there's a buzz in the air, and good things start to happen. Sudima Auckland Airport is the perfect location for your next meeting.

## SUDIMA AUCKLAND AIRPORT

18 Airpark Drive, Mangere



Sudima Auckland Airport is an award winning 4.5-star hotel set in a quiet location just 2.5kms from New Zealand's main airport. It is a Toitū carbonreduce certified hotel (previously the country's first Toitū carbonzero certified hotel) and exemplifies the best in sustainable architecture and systems, along with world-class features, facilities and services. The hotel features nine meeting spaces, restaurant & bar, gymnasium and indoor heated pool.

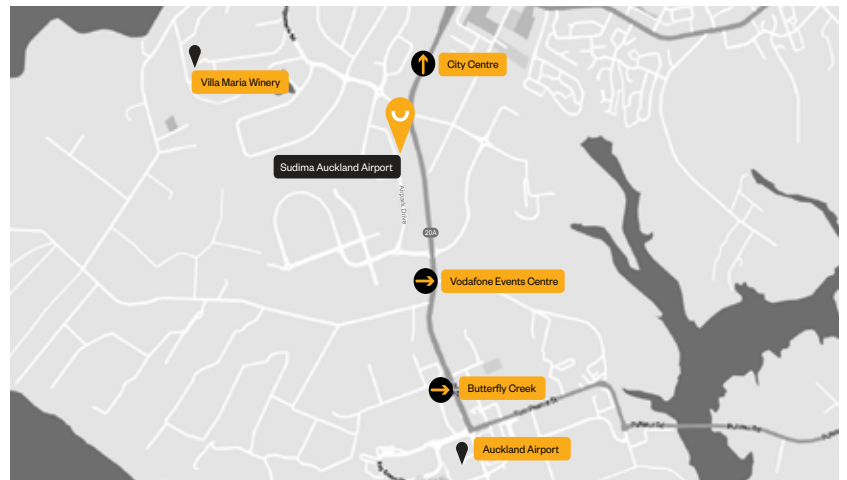



# FLEXIBLE SPACES

Whether you’ve got a whole company of rowdy employees, or a special client you need to impress, our meeting and event spaces can provide the right space, food and drink and the service you’ll need to make it a success.

## PAVILION

The Pavilion is our largest function space and can cater for up to 220 guests fully seated, and 220 persons cocktail style.

The room opens onto landscaped gardens and even has drive-in access making it ideal for automotive events and launches.

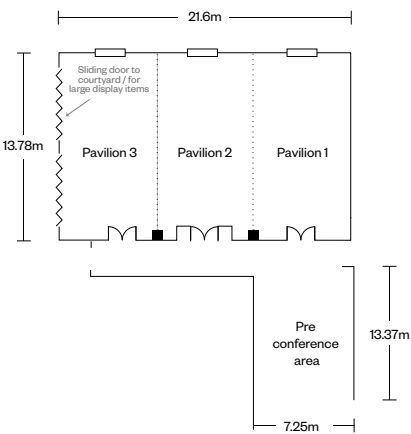

Venue	Dimension			Capacities						
	Level	Height	Area m2	Banquet	Cocktail	Classroom	Theatre	Boardroom	U-Shape	Cabaret
Pavilion 1+2+3	1	3.2	300	170	220	125	220	-	-	128

# PAVILION ONE

Pavilion room one is ideal for smaller groups of 40 when seated cabaret style or up to 70 guests in theatre style.

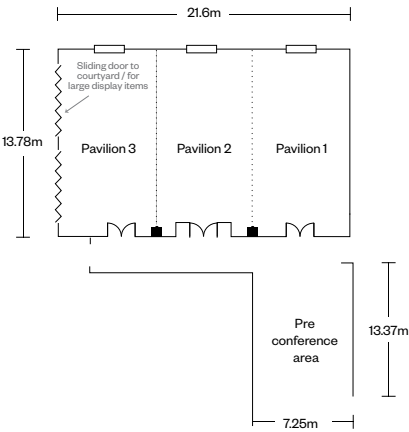

# PAVILION TWO

Pavilion room two can comfortably cater for 40 guests when seated cabaret style or up to 70 guests in cocktail style.

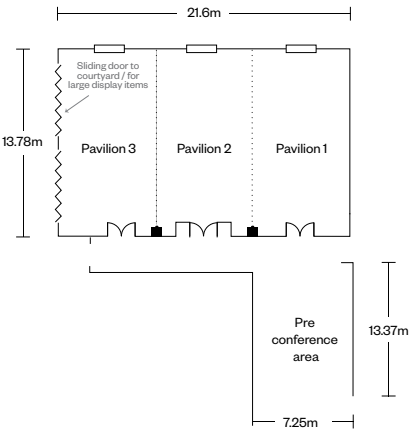

# PAVILION THREE

Pavilion room three can comfortably cater for 45 guests when seated cabaret style or up to 90 guests in theatre style.

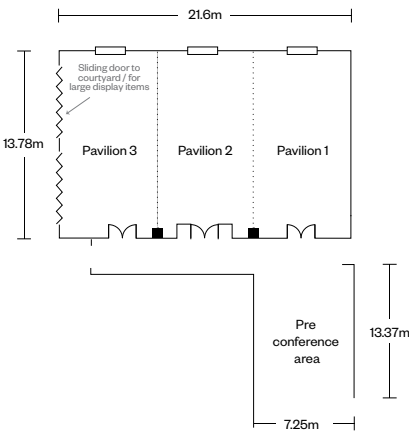

Venue	Dimension			Capacities						
	Level	Height	Area m2	Banquet	Cocktail	Classroom	Theatre	Boardroom	U-Shape	Cabaret
Pavilion 1	1	3.2	97	50	70	40	90	25	25	40
Pavilion 2	1	3.2	97	50	70	40	90	25	25	40
Pavilion 3	1	3.2	105	50	70	45	90	30	30	45

# MONTGOMERY ONE

Montgomery Boardroom one is ideal for smaller team meetings and has enough space to cater for up to 15 seated guests.

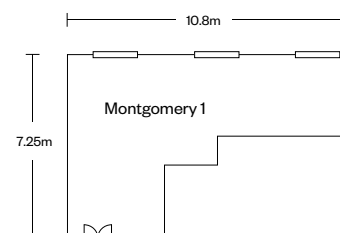

# MONTGOMERY TWO

Montgomery Boardroom two is ideal for smaller team meetings and has enough space to cater for up to 15 seated guests.

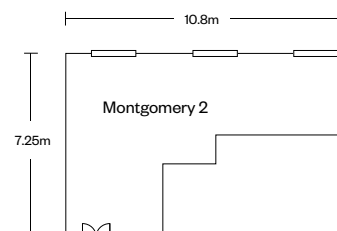

# BOARDROOM

Our Boardroom is located on level two and is ideal for a group of up to 10 guests.

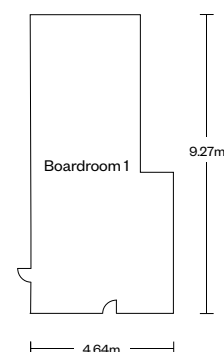

Venue	Dimension			Capacities						
	Level	Height	Area m2	Banquet	Cocktail	Classroom	Theatre	Boardroom	U-Shape	Cabaret
Montgomery 1	3	2.2	78	-	20	-	25	15	-	-
Montgomery 2	5	2.2	78	-	20	-	25	15	-	-
Boardroom 1	2	2.2	35	-	15	-	20	10	-	-



# PACKAGES

If you're looking for a venue to make your next event a stand-out success, you've made the right call. We are experts in meetings, conferences and events - from room sizes and set-ups, audio-visual requirements, venue dressing, catering and through to full event planning and everything in-between. Our package makes your planning easy, and our specialist team are here to assist with all your needs to ensure that your event is one that will impress.

## GET YOUR CONFERENCE ON!



FROM: **\$99** PER PERSON

### Package includes:

- Room & equipment (TV, projector, whiteboard & flipchart)
- Notepads & pens
- Unlimited Wifi
- Arrival tea & coffee
- Morning & afternoon tea
- Buffet lunch at Visaya restaurant

\*Minimum numbers apply. T&Cs apply.

# NETWORKING

Networking activities like drinks & canapés followed by a dinner at the end of the day, can make the event a rewarding experience for your attendees and leave them with a lasting impression.

## DRINKS PACKAGE



Enjoy a selection of canapés that will be served during your cocktail drinks. We can arrange for this to be held in the Visaya Bar. We recommend a bar tab to create the perfect event.

Please chat with our team for packages and prices.

## CORPORATE DINNER



From a buffet dinner in the Visaya Restaurant or specially designed menu, we can tailor the perfect package to suit your needs.

FROM: **\$89** PER PERSON

# GO GREEN AND RECEIVE FURTHER DISCOUNT



Your decision to choose Sudima Hotels as your meeting and conference provider is contributing to a more sustainable future. We were the first hotel group in New Zealand to be awarded Toitū Net carbonZero certification, we now focus on our Toitū carbonreduce certification and have won awards for our sustainability initiatives and achievements.



We can work with you to help reduce your event's environmental impact and offer a discount to any event partner that chooses these extra measures. There's a number of small and easy options you can choose and in return we will reduce your event cost. For example, simply remove notepads and pens from your conference or meeting by encouraging your attendees to use their devices and then share notes – it's that easy and in return we will reduce your cost by \$1 per person.

REDUCE  
COSTS BY **\$1** PER PERSON



**TODAY'S MOMENTS  
MAKE TOMORROW  
GREENER**

**SUDIMA**  
HOTELS

At Sudima Hotels, we know what we do today makes a difference to the future. We're committed to sustainability, that's why we take care of the little things that make you smile and help you make the most of your day – today, and tomorrow.

[sudimahotels.com](https://www.sudimahotels.com)

Auckland, Rotorua, Kaikoura,  
Christchurch, Queenstown



# AUDIO VISUAL

We are in partnership with a professional AV company who can provide all your AV requirements.  
Your conference & event coordinator can assist with your specific requirements.

Item	Per Day
Data Projector	included in room hire
Projector Screen	included in room hire
Pads & Pens	included in room hire
Whiteboard	included in room hire
Staging	external supplier rate
Microphones	external supplier rate
Lectern with Gooseneck Microphone and Handheld Microphone	\$250
Lectern with Gooseneck Microphone	\$150
Flipchart	\$55

# ROOM HIRE

Room	Full Day	Half Day
Pavilion (whole room)	\$3,000	\$2,500
Pavilion 1	\$1,200	\$850
Pavilion 2	\$1,200	\$850
Pavilion 3	\$1,400	\$1000
Montgomery 1	\$600	\$400
Montgomery 2	\$600	\$400
Boardroom	\$500	\$350

*Sudima Hotels reserves the right to revise pricing and/or change meeting venue should the number of attendee's change. Please be advised that Sudima Auckland Airport must approve audio-visual providers if you prefer to use an external supplier of your choosing. T&Cs apply - please ask our team for more information.*

