

EVERY VALUABLE MOMENT



T: 0800 SUDIMA (New Zealand) / +64 3 358 3139 (International)
E: conference.sca@sudimahotels.com | W: sudimahotels.com

SUDIMA
HOTELS

OUR PASSION IS YOU - WE CARE, WE DO THE RIGHT THING, WE WORK TOGETHER

At Sudima Hotels, our passion is people.

For our guests on holiday, we are a gateway to new adventures and experiences. The start of new memories. For our business guests, we are here at the end of a long day on the road or at the start of a busy day of meetings.

Regardless of the reason people choose us we feel a real responsibility to get it right. We pride ourselves on providing a friendly personal service in a welcoming and unpretentious manner, and we genuinely care – for our guests, our staff, our communities and our environment.

Our passion is you – we care, we do the right thing, we work together – and we are here to help you make the most of your day. Nothing makes us happier than when we can put a smile on your face.

MAKING BUSINESS A PLEASURE

At Sudima Hotels we see the value in every moment of a conference, event or business meeting. That's why we take care of the little things that make you smile and help you make the most of your day. Whether it's for business or pleasure, there's nothing better than people getting together with other people. The atmosphere changes, there's a buzz in the air, and good things start to happen. Sudima Christchurch Airport is the perfect location for your next meeting.

SUDIMA CHRISTCHURCH AIRPORT

550 Memorial Avenue, Christchurch Airport



Sudima Christchurch Airport is an award winning 4.5-star hotel just five minutes from the airport terminals and next door to the International Antarctic Centre. It's the perfect stepping stone to the stunning South Island. The hotel features nine meeting spaces, restaurant & bar, complimentary gym access and bicycle use during your stay.

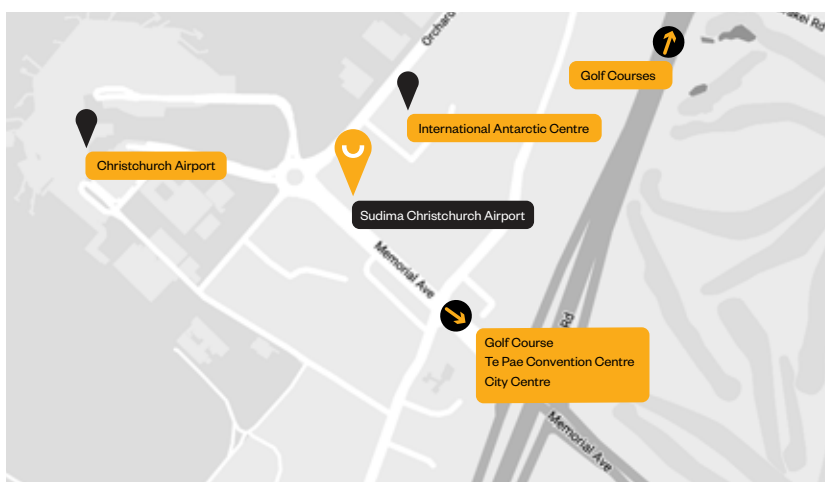

FLEXIBLE SPACES

Whether you’ve got a whole company of rowdy employees, or a special client you need to impress, our meeting and event spaces can provide the right space, food and drink and the service you’ll need.

AVON

The Avon Room is our largest function room and caters for 280 guests fully seated, and 250 persons cocktail style.

Alternatively, the room can be divided into two separate spaces for medium sized groups.

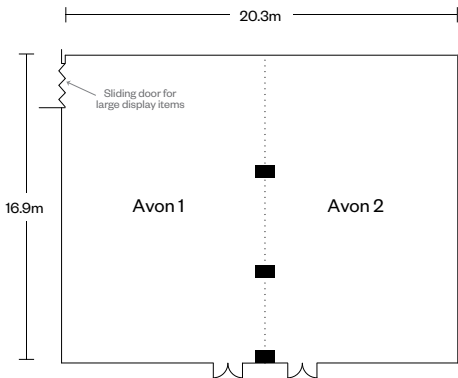

Venue	Dimensions			Capacities						
	Level	Height	Area m2	Banquet	Cocktail	Classroom	Theatre	Boardroom	U-Shape	Cabaret
Avon 1+2	G	2.9	343	150	250	140	280	60	60	144
Avon 1	G	2.9	184	110	130	80	140	30	30	72
Avon 2	G	2.9	159	90	120	60	120	30	30	72

TASMAN

The Tasman Room is ideal for meetings of up to 90 seated guests, and a great space for a group of 40 when divided.

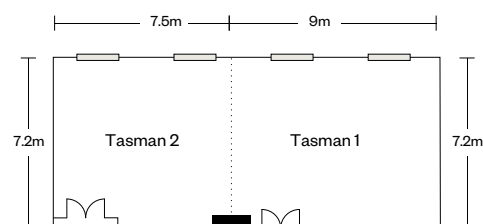

FORSYTH

Located on the first floor of the hotel, the Forsyth room holds a maximum of 30 people.

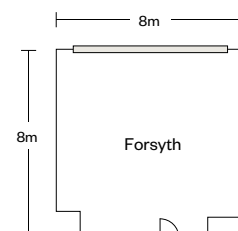

RAKAIA

Located on the ground floor, the Rakaia room is perfect for a maximum of 12 people.

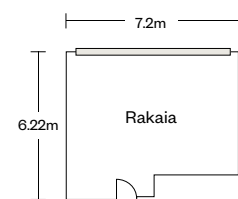

Venue	Dimensions			Capacities						
	Level	Height	Area m2	Banquet	Cocktail	Classroom	Theatre	Boardroom	U-Shape	Cabaret
Tasman 1 + 2	G	3.35	119	90	90	55	90	48	36	56
Tasman 1	G	3.35	65	50	50	27	50	24	20	32
Tasman 2	G	3.35	54	40	40	24	40	24	16	24
Forsyth	1	2.4	64	-	-	24	30	24	20	-
Rakaia	G	2.2	45	-	-	12	-	12	10	-

HOPE

Natural light floods the Hope Room and is a great space for a smaller group

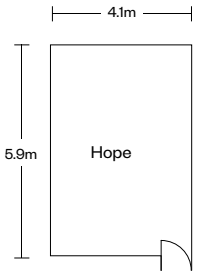

ASHLEY

The Ashley room is ideal for a smaller team and is equipped with the necessary equipment to make your day productive.

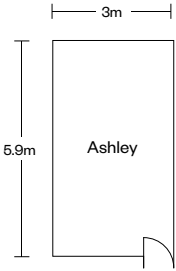

LEWIS

The Lewis room fits a small team of up to 8 guests and is perfect for an off-site meeting.

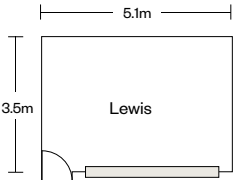

Venue	Dimensions			Capacities						
	Level	Height	Area m2	Banquet	Cocktail	Classroom	Theatre	Boardroom	U-Shape	Cabaret
Hope	G	2.7	24	-	-	-	-	10	-	-
Ashley	G	2.7	18	-	-	-	-	10	-	-
Lewis	G	3.0	18	-	-	-	-	8	-	-

PACKAGES

We have devised packages that will help you in planning your next meeting and conference. Both packages are flexible and can be further tailored to meet your needs. Just talk to our team.

GET YOUR CONFERENCE ON!



FROM: **\$79** PER PERSON

Package includes:

- Room & equipment (TV, projector, whiteboard & flipchart)
- Notepads & pens
- Unlimited Wifi
- Arrival tea & coffee
- Morning & afternoon tea
- Lunch at Acheron restaurant

*Minimum numbers apply. T&Cs apply.

NETWORKING

Networking activities like drinks & canapés followed by a dinner at the end of the day, can make the event a rewarding experience for your attendees and leave them with a lasting impression.

DRINKS & CANAPÉ PACKAGE



Enjoy a selection of canapés that will be served during your cocktail drinks. We can arrange for this to be held in the Acheron Bar. We recommend a bar tab to create the perfect event.

FROM: **\$26** PER PERSON

CORPORATE DINNER



From an à la carte dinner in the Acheron Restaurant or specially designed menu, we can tailor the perfect package to suit your needs.

FROM: **\$69** PER PERSON

GO GREEN AND RECEIVE FURTHER DISCOUNT



Your decision to choose Sudima Hotels as your meeting and conference provider is contributing to a more sustainable future. We were the first hotel group in New Zealand to be awarded Toitū Net carbonZero certification, we now focus on our Toitū carbonreduce certification and have won awards for our sustainability initiatives and achievements.



We can work with you to help reduce your event's environmental impact and offer a discount to any event partner that chooses these extra measures. There's a number of small and easy options you can choose and in return we will reduce your event cost. For example, simply remove notepads and pens from your conference or meeting by encouraging your attendees to use their devices and then share notes – it's that easy and in return we will reduce your cost by \$1 per person.

REDUCE
COSTS BY **\$1** PER PERSON



**TODAY'S MOMENTS
MAKE TOMORROW
GREENER**

SUDIMA
HOTELS

At Sudima Hotels, we know what we do today makes a difference to the future. We're committed to sustainability, that's why we take care of the little things that make you smile and help you make the most of your day – today, and tomorrow.

[sudimahotels.com](https://www.sudimahotels.com)

Auckland, Rotorua, Kaikoura,
Christchurch, Queenstown

AUDIO VISUAL

We are in partnership with a professional AV company who can provide all your AV requirements. Your conference & event coordinator can assist with your specific requirements.

Item	Per Day
Data projector	\$200
Projector Screen	\$100
50" Flatscreen TV	\$100
Lectern	\$100
Flipchart, Pads & Pens	\$50
Microphones	\$50
Whiteboard	\$50
Staging & Dance floor	external supplier rate

ROOM HIRE

Room	Per Day
Avon 1 & 2 (whole room)	\$1200
Avon 1	\$800
Avon 2	\$800
Tasman 1 & 2 (whole room)	\$1000
Tasman 1	\$600
Tasman 2	\$600
Forsyth	\$600
Hope, Ashley, Lewis & Rakaia	\$300

Sudima Hotels reserves the right to revise pricing and/or change meeting venue should the number of attendee's change. Please be advised that Sudima Christchurch Airport must approve audio-visual providers if you prefer to use an external supplier of your choosing. T&Cs apply - please ask our team for more information.

A: 550 Memorial Ave, Christchurch 8053
T: 0800 SUDIMA (New Zealand) / +64 3 358 3139 (International)
E: conference.sca@sudimahotels.com | W: sudimahotels.com

SUDIMA
HOTELS