

EDISONS

Whangamata



WELCOME TO EDISONS, A TRULY
EXCEPTIONAL WEDDING VENUE
NESTLED WITHIN THE HISTORIC
WALLS OF THE OLD ICONIC
WHANGAMATA CINEMA.



THE SPACE

AT EDISONS, EVERY ASPECT OF THE SPACE HAS BEEN THOUGHTFULLY CURATED TO CREATE A DISTINCT AMBIANCE THAT PAYS HOMAGE TO THE BUILDING'S HERITAGE WHILE OFFERING A VERSATILE CANVAS FOR YOUR SPECIAL OCCASION. THE SUBTLE ART DECO INFLUENCE ADDS A TOUCH OF ELEGANCE, AND THE MINIMALIST DESIGN ALLOWS YOU THE FREEDOM TO PERSONALISE THE SPACE TO MATCH YOUR UNIQUE VISION.

THE CINEMA HALL

The cinema hall ensures a seamless experience regardless of the weather. This magnificent space can adapt to suit your needs, whether it's hosting a sit-down dinner or transforming into a vibrant dance floor.

SPECS

9 x 17m (truss height: 4.5m)
BOH Kitchen 3 x 4m

THE LANEWAY

The laneway, a special feature of Edisons, extends beyond the venue, providing an inviting outdoor extension to the festivities. It serves as a delightful spot for cocktail hour or a few outdoor seats, allowing guests to enjoy the fresh air amidst the celebration, particularly during the pleasant summers in Whangamatā.

SPECS

2.5 x 17.5m

FLOOR PLAN

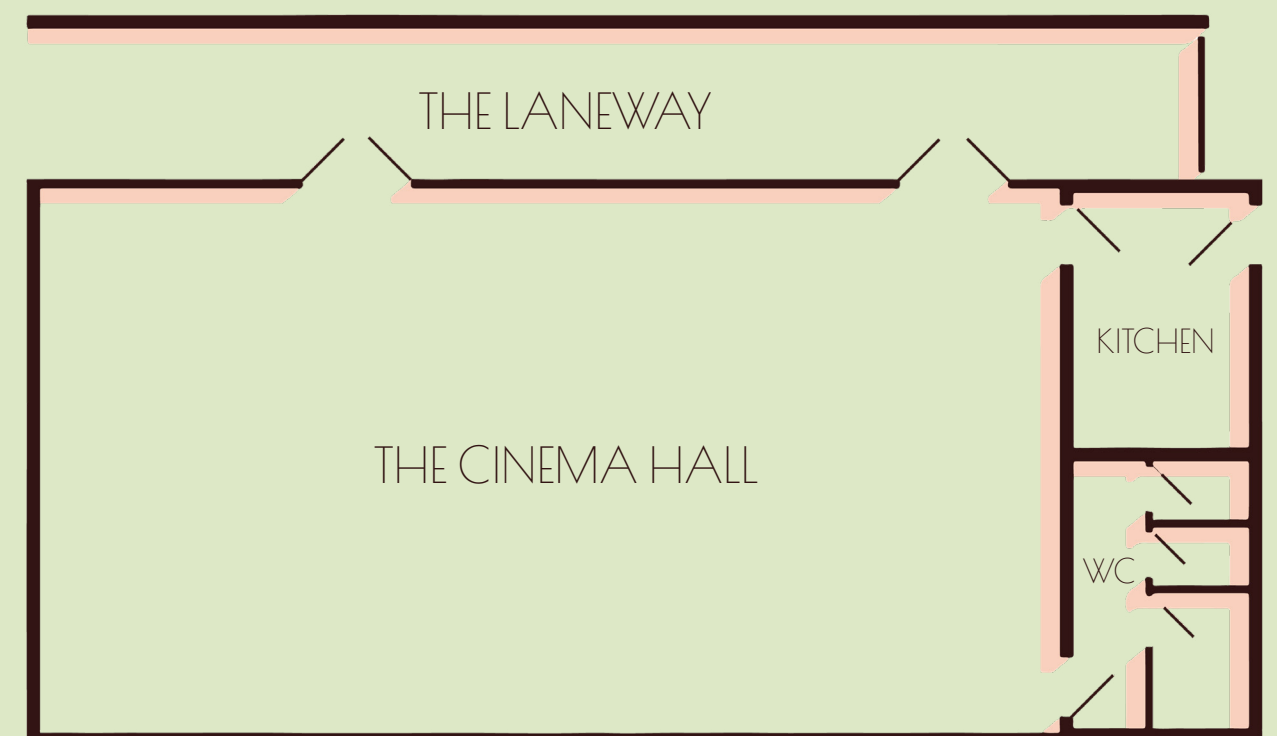

WEDDING PACKAGE

WEDDING PACKAGE

Friday or Saturday wedding: \$3900 + GST

Sunday to Thursday wedding: \$3400 + GST

INCLUSIONS

- 2 day venue hire (day before for setup, and day of wedding)
- All Edisons furniture and decor (see following page for detail)
- Wedding day run sheet, and on the day coordinator
- Chiller trailer
- Service kitchen with oven, sink and prep benches
- Sound system for PA and music
- Glassware
- Plateware and cutlery for up to 50 pax

FURNITURE / DECOR

Folding walnut chairs: 100 available

Wooden tables: 10 available

Bar leaners: 7 available

Stage: 3 units at 1.2m x 1.8m

Projector

Vintage Tea Trollies: 2 available

Champagne bucket: 1 available

Set of glass vases for candles or flowers: approx 50 at varying sizes

Set of gold candelabras: 30 available at varying heights

VENUE CAPACITY

Seated dinner/reception event: 100 pax

Cocktail style event: 160 pax

ADDITIONAL PACKAGES

Champagne tower package: \$400 + GST

- 4 bottles of Mumm Champagne
- 30 x Champagne coupes
- Champagne bucket

Sheer curtain hireage and installation: \$450 + GST

- Add subtle elegance and transform the space with drapery hung along the west wall.

AT EDISONS, WE UNDERSTAND THE SIGNIFICANCE OF YOUR WEDDING DAY, REGARDLESS OF ITS STYLE OR SCALE. WHETHER YOU CHOOSE A SMALL INTIMATE GATHERING, A SOPHISTICATED SIT DOWN DINNER OR A RELAXED COCKTAIL-STYLE EVENING, WE CATER TO ALL YOUR PREFERENCES. OUR VERSATILITY ENSURES THAT YOUR SPECIAL DAY IS CELEBRATED JUST THE WAY YOU ENVISION IT.



OUR PARTNERS

OUR TRUSTED TEAM OF INDUSTRY EXPERTS TAKE GREAT PRIDE IN THEIR WORK, AND WE HAVE FULL CONFIDENCE THAT THEY WILL EXCEED EXPECTATIONS AS SUPPLIERS AND STYLING PARTNERS FOR EDISONS.

CATERING

Amador Kitchen
Banh Mi Caphe
Blank Canvas Catering
Food by Wild Wood Fire
Olive Jay Cakes
Pasta Paradiso
Sugar Fish Catering

EVENT HIRE EQUIPMENT

Whangamatā Party Hire
Peninsula Party Hire
Waihi Hire

PHOTOGRAPHERS

Emily Hart - A Little Bit Snappy
Jackson Bright
Jacob Haverland
Justin Aiken

WEDDING PLANNING

Coromandel Weddings
Toast

FLORISTRTRY & PLANTS

Flowers & Fantails
On My Hand
The Green Room

TABLEWARE

Royal Laboratorie
Table. Linen

FURNITURE

Twelve Tables

We are always open to your preferences and collaborating with new and talented creative vendors.

FREQUENTLY ASKED QUESTIONS

IS THERE PARKING?

There is street parking available, but we don't have any allocated private parking, therefore we encourage walking or car pooling to events.

WHO SETS UP & WHEN?

You will have access to the events space from 10am the day prior to your wedding to get set up. We will meet to give you access to the venue, and liase with any vendors who are setting up the day before or day of your wedding.

WHEN IS PACK DOWN?

All hired and personal items will need to be removed from the venue by 9am the following day.

ARE THERE NOISE RESTRICTIONS?

Our sound system is perfect for music and speeches during the event. Should you wish to have more than a Spotify playlist, we recommend booking a DJ or band for your event. Thames Coromandel District Council noise restrictions kick in at 10pm so our team will work with your entertainment on the night to make sure the levels are perfect. The outdoor laneway will close at 11pm, to reduce noise impact on neighbouring properties.

HOW DO BEVERAGES WORK?

Cinema Lane holds an on licence, which means that we are responsible for the selling and service of alcohol at your wedding. We have a few different beverage options available and we are also open to any preferences you may have.

WHAT TIME DOES EDISONS CLOSE?

The latest time for the bar to close and band/DJ to finish is 11.30pm, with guests exiting by midnight.

WHAT IS THE SECURITY BOND?

We may charge a security bond fee of up to \$500, which will be invoiced 30 days prior to your event. After your event, we will inspect the premises within 48 hours and will refund your bond to your nominated bank account within 7 days provided that there is no damage to the property.

IS SMOKING ALLOWED AT EDISONS?

Cinema Lane is a smoke free premises. If you or your guests would like to smoke/vape, please exit the premise via the laneway to Port Road footpath where you are able to smoke.

PAYMENT TERMS

A 50% deposit of the booking fee will be paid at the time of your booking to secure your booking/event date. The balance payment, estimated bar spend and security bond will be invoiced 30 days prior to your event. All amounts payable will be in NZD and GST inclusive.

GET IN TOUCH

021 0228 4998 | hello@edisonsevents.co.nz

